

# BIN



# WAREHOUSE

Solutions Murales PROSLAT inc.  
225 Industriel Blvd  
Chateaugay (QC) J6J 4Z2  
1 888 691-2944

US Patent No: 6,315,136B1 All Rights Reserved  
International Patents Pending

## FOR FILEBOXES - ASSEMBLY INSTRUCTIONS

### TOOLS REQUIRED

1. Powered Screwdriver with #2 Phillips-Head Tip



### PARTS LIST

1. (12) Horizontal Crossbars
2. (04) Center Verticals
3. (02) Right Front & Left Rear Corner Verticals
4. (02) Left Front & Right Rear Corner Verticals
5. (04) Front & Rear Grid Connecting Tubes
6. (04) Wall Mount Brackets
7. (18) Horizontal Slidrails

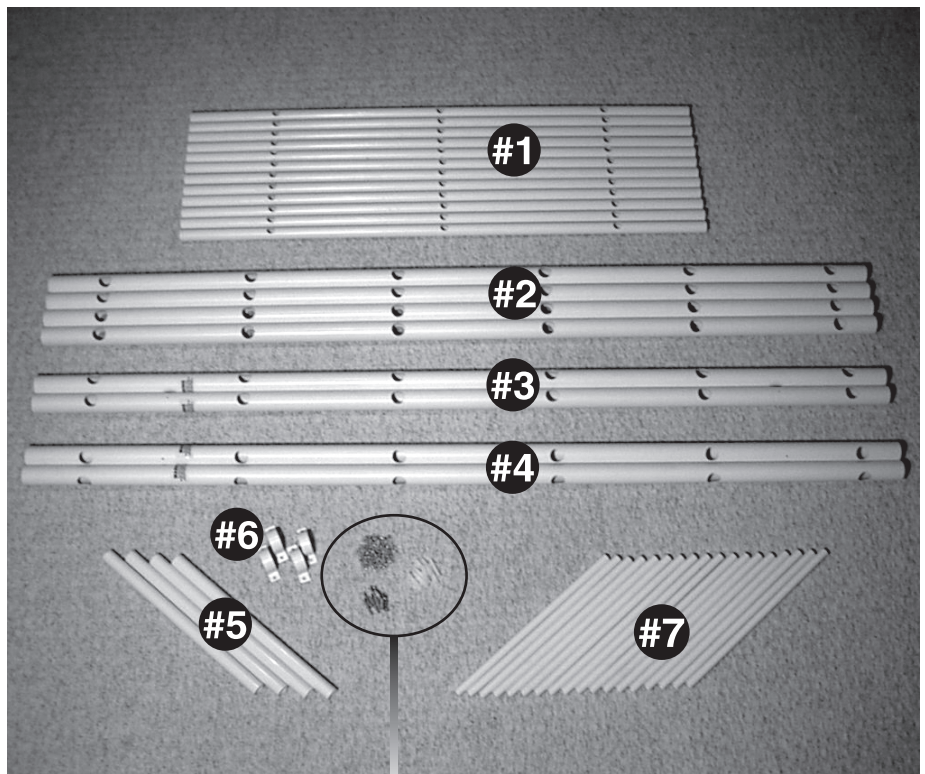

### FASTENER LIST

1. (92) #06 x 1/2" Fastening Screws
2. (08) #10 x 1-1/4" Fastening Screws
3. (08) Plastic Wall Anchors



### NOTE:

Separate All Parts into Groups (as shown) and Familiarize. Read All Instructions Before Beginning Assembly

# IMPORTANT: Do not install any fasteners until instructed!

Numbers in **BOLD** indicate item number from Parts/Fastener Lists.

## FRONT GRID ASSEMBLY

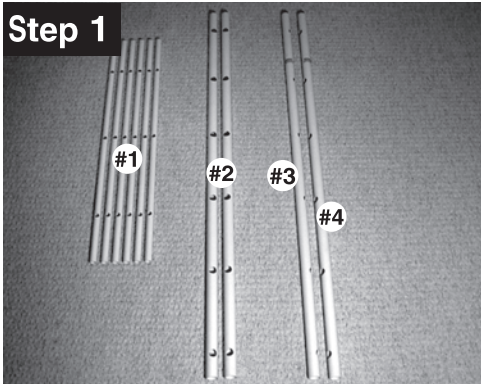

Parts Needed:  
6 of #1 2 of #2  
1 of #3 1 of #4

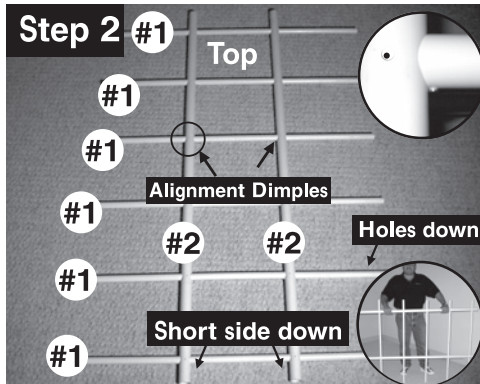

6 Horizontal Crossbars (#1) inserted through 2 Center Verticals (#2) (holes facing down)  
*Tip: When installing second Center Vertical, stand assembly with Horizontal Crossbars placed on floor and push down second Center Vertical to Alignment Dimples.*

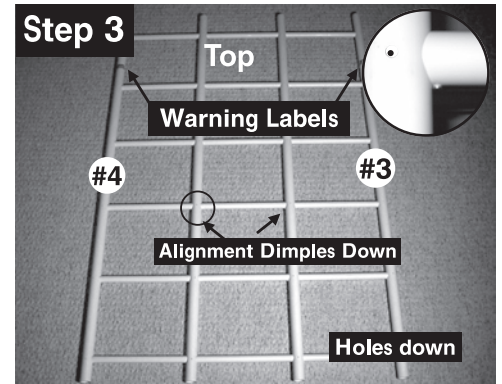

1 Left Front Corner Vertical (#4) and 1 Right Front Corner Vertical (#3) - Placed on Horizontal Crossbars (Holes Facing Down)

## REAR GRID ASSEMBLY

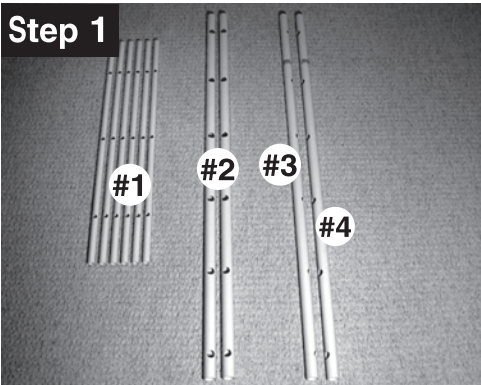

Parts Needed:  
6 of #1 2 of #2  
1 of #3 1 of #4

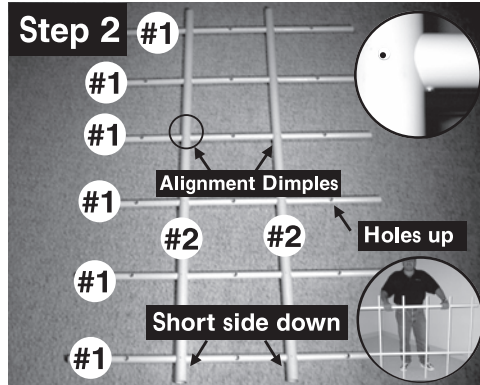

6 Horizontal Crossbars (#1) inserted through 2 Center Verticals (#2) (holes facing up)  
*Tip: When installing second Center Vertical, stand assembly with Horizontal Crossbars placed on floor and push down second Center Vertical to Alignment Dimples.*

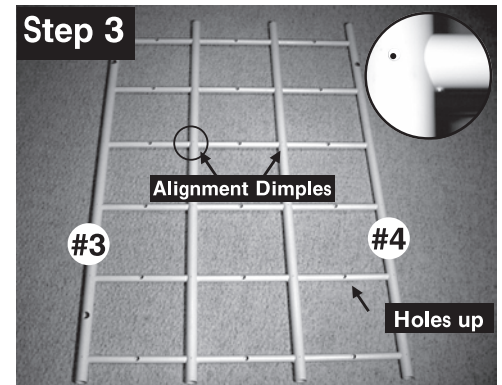

1 Right Rear Corner Vertical (#4) and 1 Left Rear Corner Vertical (#3) - Placed on Horizontal Crossbars (Holes Facing Up)

## SLIDERAIL ASSEMBLY

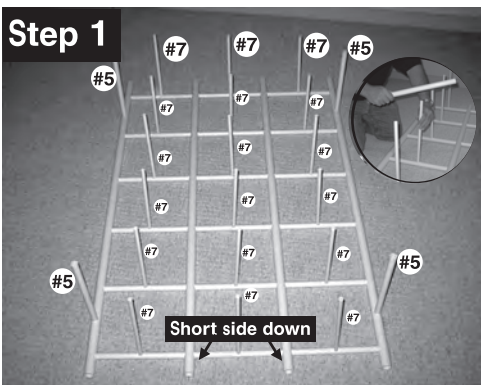

18 Horizontal Sliderails (#7) and 4 Front and Rear Grid Connecting Tubes (#5) inserted in Rear Grid

*Tip: If Necessary, Tap Horizontal Slide Rails to be sure Slide Rails are Fully Inserted*



Fastening Horizontal Sliderails (#7) in Rear Grid using 18 - #06 x 1/2" Fastening Screws (#1)  
*Tip: Start at top row and work down*

**Note: One fastener per sliderail - bottom hole only**



All Horizontal Sliderails fastened to Rear Grid. Now Fasten 4 Front and Rear Grid Connecting Tubes (#5) to Rear Grid using 4 - #06 x 1/2" Fastening Screws (#1)

**Note: Use One Fastener Only**



# IMPORTANT: Do not install any fasteners until instructed!

Numbers in **BOLD** indicate item number from Parts/Fastener Lists.

## JOINING FRONT TO REAR GRID

### Step 1

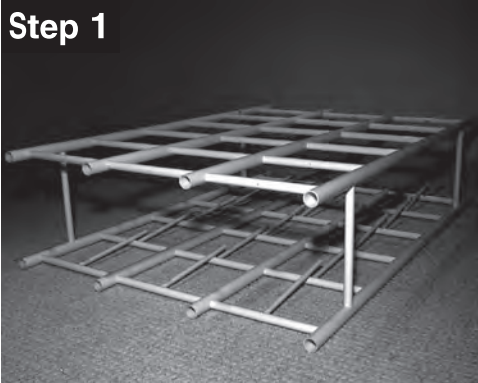

Join Front to Rear Grid by inserting 4 Front & Rear Grid Connecting Tubes (**#5**) into Front Grid Assembly  
**Note: Do Not Fasten at This Time**

### Step 2



Insert and fasten 18 Horizontal Sliderails (**#7**) into Front Grid Assembly using 18 - #06 x 1/2" Fastening Screws (**#1**) **Note: Fasteners in Bottom Hole Only, Work from Bottom Row to Top Row Making Sure All Tubes are Fully Inserted!**

### Step 3



Turn unit upright and place firmly against wall where unit is to be mounted.

## FASTENING VERTICALS & FRONT & REAR GRID CONNECTING TUBES

### Step 1



Fasten 4 Front & Rear Grid Connecting Tubes (**#5**) to Front Grid Assembly Using 4 - #06 x 1/2" Fastening Screws (**#1**)

### Step 2

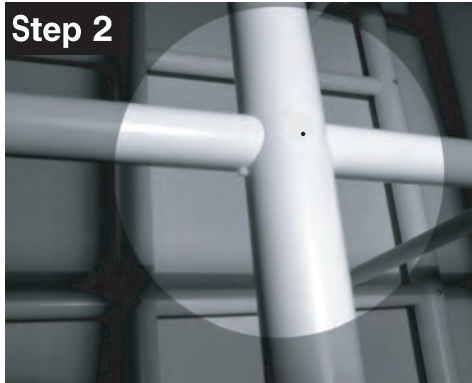

Make sure unit is Straight and Square, and all Verticals are Pressed Firmly together and against alignment dimples

### Step 3



Fasten All Verticals to Horizontals Making sure all joints are pressed firmly together and tight against alignment dimples using 48 - #06 x 1/2" Fastening Screws (**#1**)  
**Note: Fasteners in Holes Facing YOU Only**

## FASTENING BIN WAREHOUSE TO WALL

### Step 1

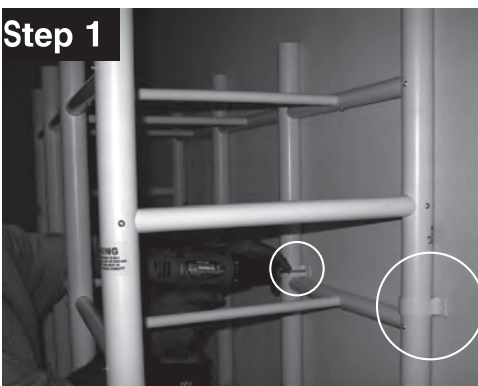

Place 4 wallmount brackets (**#6**) over 4 Rear Verticals above 2nd Horizontal Crossbar (**#1**) and fasten to wall using 8 - #10 x 1-1/4" Fastening Screws (**#2**)

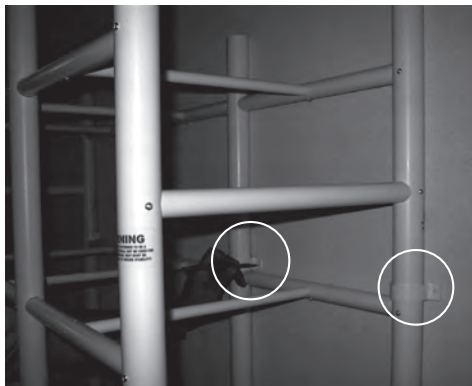

**Note: If mounting into Drywall or Masonry, mark & drill 1/4" holes and insert plastic wall anchors - and proceed with step 1-**



**Unit must be attached to wall to keep from tipping over!**

**Congratulations!**

**We Hope You Enjoy Your Bin Warehouse!**