

12-TOTE COMPACT MODEL ASSEMBLY INSTRUCTIONS

TOOLS REQUIRED

1. Powered Screwdriver with #2 Phillips-Head Tip

PARTS LIST

1. (8) Horizontal Crossbars
2. (4) Center Verticals
3. (2) Left & Right Rear Corner Verticals
4. (1) Left Front Corner Vertical
5. (1) Right Front Corner Vertical
6. (4) Wall Mount Flanges
7. (4) Wall Mount Extension Tubes
8. (12) Horizontal Sliderails

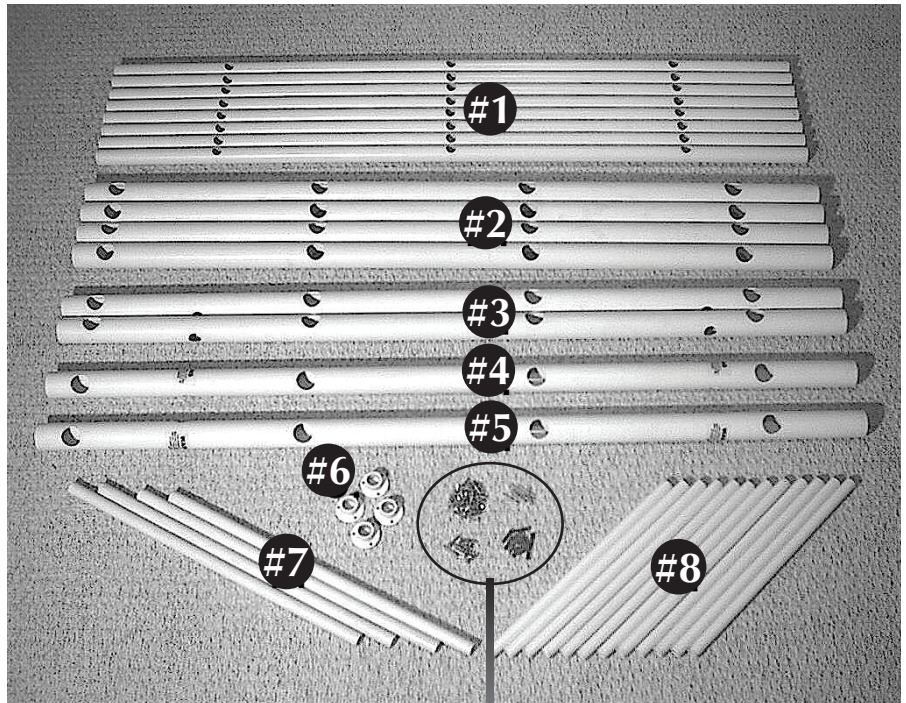

FASTENER LIST

1. (60) #06 x 1/2" Fastening Screws
2. (08) #08 x 3/4" Wall Mount Extension Tube Fastening Screws
3. (12) #10 x 1-1/2" Wall Mount Flange Screws
4. (12) Plastic Wall Anchors

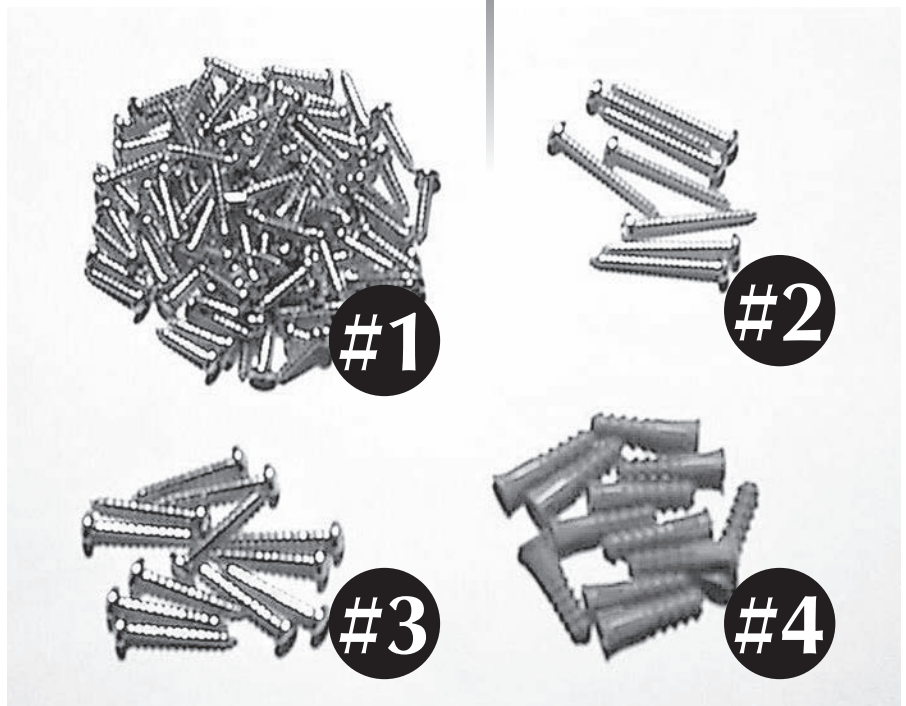

TIP

Separate All Parts into Groups (as shown) and Familiarize. Read All Instructions Before Beginning Assembly.

IMPORTANT: Do not install any fasteners until instructed!

Numbers in **BOLD** indicate item number from Parts/Fastener Lists.

FRONT GRID ASSEMBLY

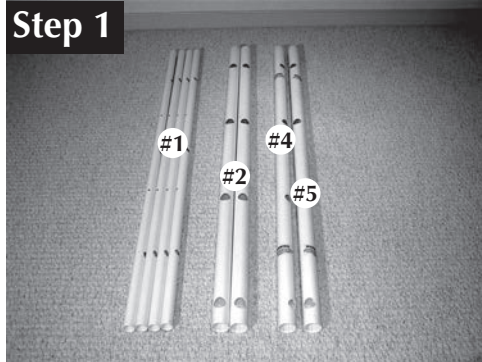

Parts Needed:
4 of #1 2 of #2
1 of #4 1 of #5

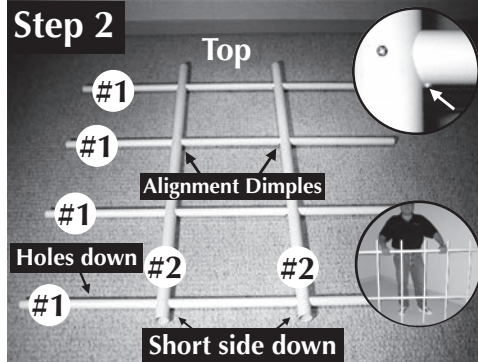

4 Horizontal Crossbars (#1) inserted through
2 Center Verticals (#2)
Tip: When installing second Center Vertical, stand assembly with Horizontal Crossbars placed on floor and push down second Center Vertical to Alignment Dimples.

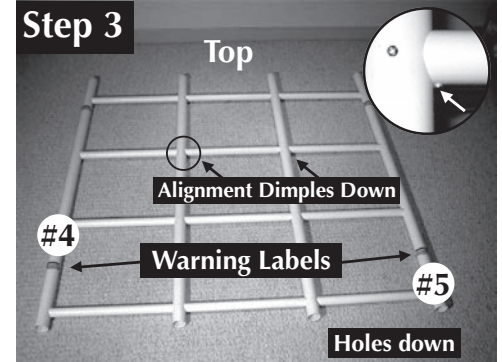

1 Left Front Corner Vertical (#4) and 1 Right Front Corner Vertical (#5) Placed on Horizontal Crossbars

REAR GRID ASSEMBLY

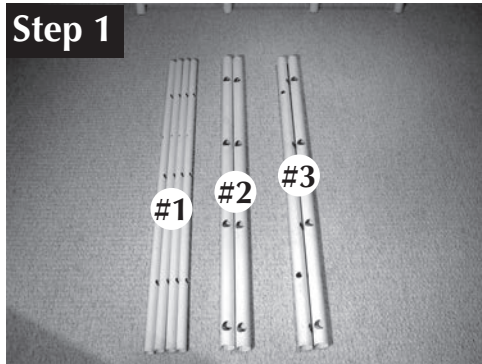

Parts Needed:
4 of #1 2 of #2
2 of #3

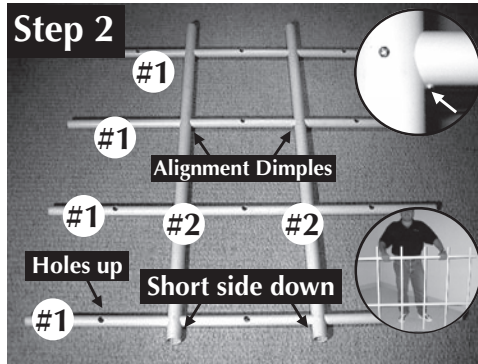

4 Horizontal Crossbars (#1) inserted through
2 Center Verticals (#2)
Tip: When installing second Center Vertical, stand assembly with Horizontal Crossbars placed on floor and push down second Center Vertical to Alignment Dimples.

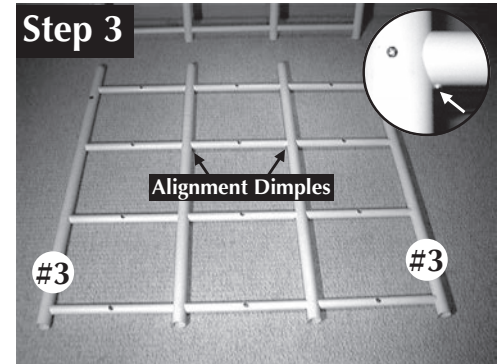

2 Left and Right Rear Corner Verticals (#3) Placed on Horizontal Crossbars

SLIDERAIL ASSEMBLY

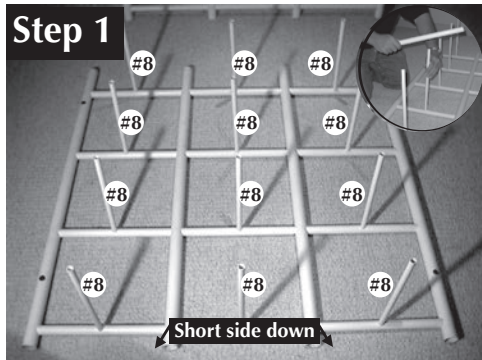

12 Horizontal Sliderails (#8) inserted in Rear Grid

Tip: If necessary tap Horizontal Sliderails to be sure Sliderails are fully inserted

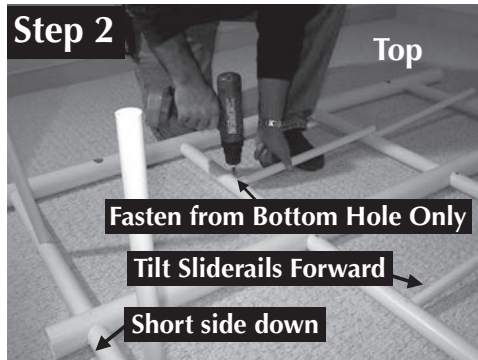

Fastening Horizontal Sliderails (#8) in Rear Grid using 12 - #06 x 1/2" Fastening Screws (#1)
Note: Start at top row and work down
Use only one fastener - Bottom Hole Only

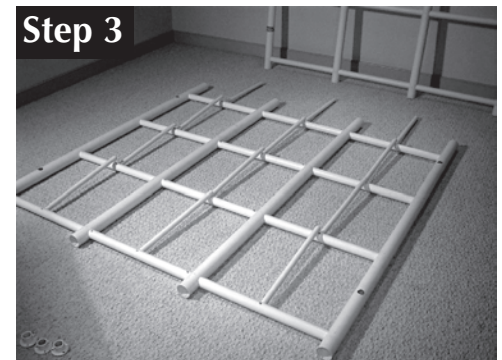

All Horizontal Sliderails fastened to Rear Grid
Note: Fastener in Bottom Hole Only

IMPORTANT: Do not install any fasteners until instructed!

JOINING FRONT TO REAR GRID

Step 1

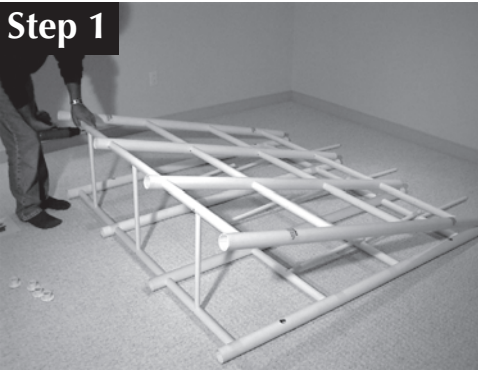

Insert Bottom Sliderails (#8) into Front Grid Assemble and fasten (*making sure fully inserted*) using 3- #06 x 1/2" Fastening Screws (#1)
Note: Fasteners in Bottom Hole Only

Step 2

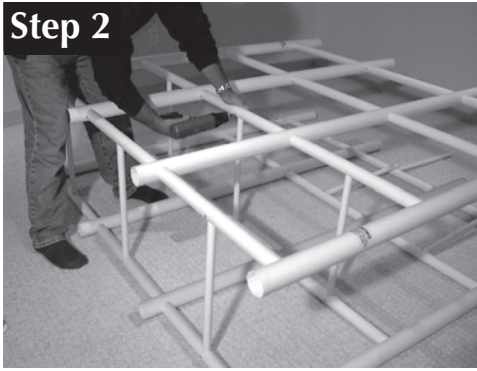

Insert and fasten next 3 rows of Sliderail to Front Grid using 9 - #06 x 1/2" Fastening Screws (#1)
Note: Fasteners in Bottom Hole Only

Step 3

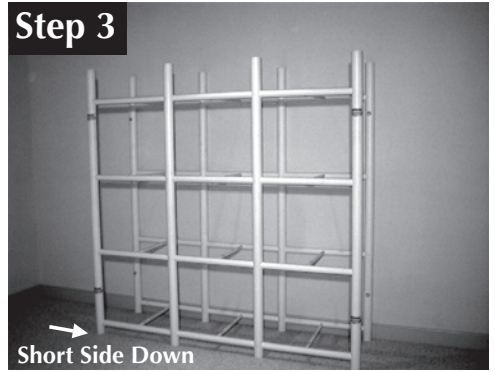

Turn unit upright and place firmly against wall where unit is to be mounted.

FASTENING VERTICALS & WALLMOUNT TUBES

Step 1

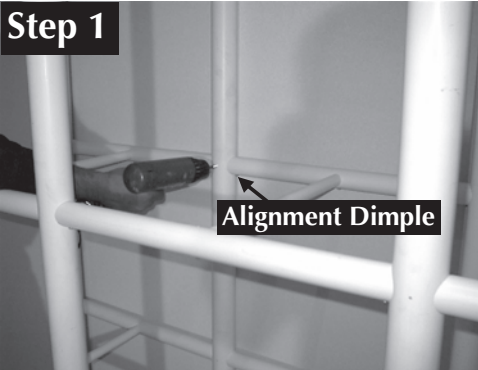

Fasten all Verticals to Horizontals. Make sure all joints are pressed firmly together, tight and against alignment dimples.
32 - #06 x 1/2" Fastening Screws (#1)
Note: 1 Fastener Per Joint, each grid, Front Side Only

Step 2



Move unit away from wall and insert 4 Wallmount Extension Tubes (#7) at 4 Locations. Fasten With 8 - #08 x 3/4" Extension Tube Fastening Screws (#2)
Note: 1 Fastener Per Joint Front Side Only

Step 3

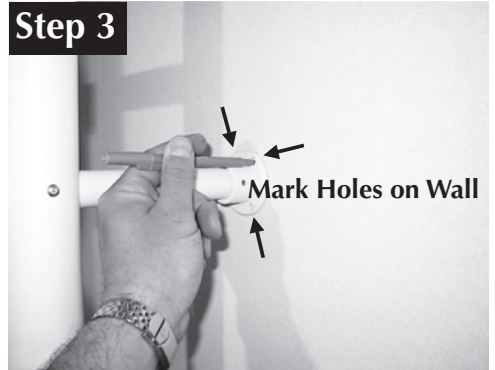

Slide Wallmount Flange (#6) into Wallmount Tube (#7) Place unit against wall where it is to be mounted and mark Wall Flange holes.
Note: Do NOT fasten at this time. Make sure unit remains in position at all 4 locations while marking holes.

FASTENING BIN WAREHOUSE TO WALL



Move unit away from wall and remove Wall Flanges from Tubes and mount Flanges to wall using 12 #10 x 1-1/2" Wall Mount Flange Screws (#3) and Plastic Wall Anchors (#4) if needed.
Note: If mounted into Masonry or Drywall, drill three 1/4" holes to accept Plastic Wall Anchors.



Slide unit back against wall while inserting all 4 Wallmount Extension Tubes (#7) into Wallmount Flanges (#6) and fasten with 4 - #06 x 1/2" Fastening Screws (#1).
Note: 1 Screw per Flange



Unit MUST be attached to wall to prevent from tipping over!

Congratulations!

We Hope You Enjoy Your Bin Warehouse!